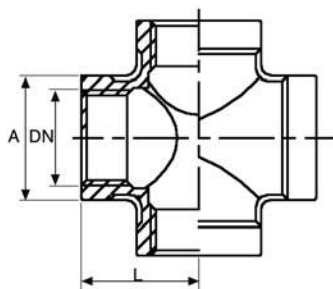
**168/316L****MEZZO MANICOTTO**

- HALF SOCKET
- MUFFE H.L.
- DEMI MANCHON
- MEDIO MANGUITO

**Da tubo S.S.**  
From seamless pipe

**MATERIAL:** AISI 316L / W. 1.4404  
**NORM:** UNI/DIN EN 10241 [ex DIN 2986]  
**THREAD:** EN 10226-1 [ex ISO 7/1]  
**RATING:** 150 PSI – PN10

CODE	DN	DN1 inch	D2 mm	L mm	S mm		
168108316	6	1/8"	15	8	2,35	7	10
168104316	8	1/4"	18,5	11	2,4	12	10
168308316	10	3/8"	21,3	12	2,05	14	10
168102316	15	1/2"	26,6	15	2,65	26	10
168304316	20	3/4"	31,8	17	2,55	36	10
168100316	25	1"	39,5	20	3,05	64	10
168114316	32	1 1/4"	48,3	22	3,05	88	5
168112316	40	1 1/2"	54,5	22	3,1	105	5
168200316	50	2"	66,2	26	2,95	164	5
168212316	65	2 1/2"	82	30	4,5	245	1
168300316	80	3"	95	34	3,05	312	1
168400316	100	4"	121,4	40	3,55	630	1

**180****CROCE FEMMINA**

- CROSS
- KREUZSTÜCK
- CROIX
- CRUZ

**MATERIAL:** AISI 316 / 1.4401 / 1.4408  
**THREAD:** EN 10226-1 [ex ISO 7/1]  
**RATING:** 150 PSI – PN10

CODE	DN	DN inch	A mm	L mm		
180108316	6	1/8"	15,2	17	38	10
180104316	8	1/4"	19,7	18,5	72	10
180308316	10	3/8"	23,3	22,9	103	10
180102316	15	1/2"	28	26,8	144	10
180304316	20	3/4"	34,8	32	249	10
180100316	25	1"	43,6	37,5	435	10
180114316	32	1 1/4"	53	45,9	701	5
180112316	40	1 1/2"	58	47,6	754	5
180200316	50	2"	71	58	1258	2
180212316	65	2 1/2"	87	69	1770	2
180300316	80	3"	99	77	2031	1
180400316	100	4"	125	97	3490	1

**A 30 30**

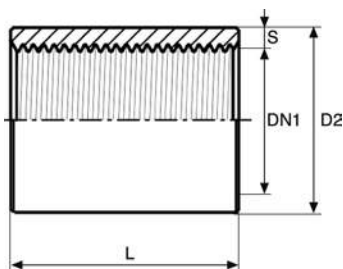

**268/304L**

**MANICOTTO**

- SOCKET
- MUFFE G.L.
- MANCHON
- MANGUITO

**MATERIAL:** AISI 304L / W. 1.4307  
**NORM:** UNI/DIN EN 10241 (ex DIN 2986)  
**THREAD:** EN 10226-1 (ex ISO 7/1)  
**RATING:** 150 PSI – PN10

**Da tubo S.S.  
From seamless pipe**

CODE	DN	DN1 inch	D2 mm	L mm	S mm			
268108304	6	1/8"	15	17	2,35	15	10	800
268104304	8	1/4"	18,5	25	2,4	30	10	500
268308304	10	3/8"	21,3	26	2,05	34	10	400
268102304	15	1/2"	26,6	34	2,65	68	10	240
268304304	20	3/4"	31,8	36	2,55	83	10	140
268100304	25	1"	39,5	43	3,05	137	10	150
268114304	32	1 1/4"	48,3	48	3,05	226	5	100
268112304	40	1 1/2"	54,5	48	3,1	266	5	70
268200304	50	2"	66,2	56	2,95	352	5	50
268212304	65	2 1/2"	82	65	4,5	530	1	24
268300304	80	3"	95	71	3,05	650	1	18
268400304	100	4"	121,4	83	3,55	1305	1	10

**A 30 30**

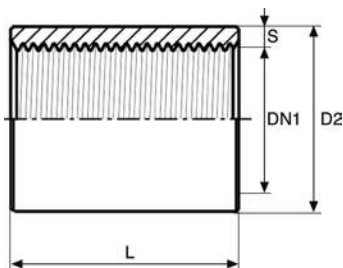

**268/316L**

**MANICOTTO**

- SOCKET
- MUFFE G.L.
- MANCHON
- MANGUITO

**MATERIAL:** AISI 316L / W. 1.4404  
**NORM:** UNI/DIN EN 10241 (ex DIN 2986)  
**THREAD:** EN 10226-1 (ex ISO 7/1)  
**RATING:** 150 PSI – PN10

**Da tubo S.S.  
From seamless pipe**

CODE	DN	DN1 inch	D2 mm	L mm	S mm			
268108316	6	1/8"	15	17	2,35	15	10	800
268104316	8	1/4"	18,5	25	2,4	30	10	500
268308316	10	3/8"	21,3	26	2,05	34	10	400
268102316	15	1/2"	26,6	34	2,65	68	10	240
268304316	20	3/4"	31,8	36	2,55	83	10	140
268100316	25	1"	39,5	43	3,05	137	10	150
268114316	32	1 1/4"	48,3	48	3,05	226	5	100
268112316	40	1 1/2"	54,5	48	3,1	266	5	70
268200316	50	2"	66,2	56	2,95	352	5	50
268212316	65	2 1/2"	82	65	4,5	530	1	24
268300316	80	3"	95	71	3,05	650	1	18
268400316	100	4"	121,4	83	3,55	1305	1	10

## INFORMAZIONI TECNICHE

### Technical info

I raccordi filettati IN OX sono usati per tipici impianti di trasporto acqua, aria, gas, olio e vapore.

La "Classe" di prodotto dei raccordi inox è 150 psi.

Il range di temperatura di utilizzo è -20 / +200 °C, mentre la pressione di esercizio è dipendente dalla temperatura secondo tabella seguente (dati ricavati dagli standards ISO 4144 e ANSI/MSS SP-114)

Threaded fittings are used for typical plants to transport water, air, gas, oil and steam.

The "class" product of stainless steel fittings is 150 psi.

The range of operating temperature is -20 / + 200 ° C while the pressure depend from temperature in according to the following table (data obtained from the standards ISO 4144 and ANSI / MSS SP-114).

T (C°)		P (bar)
Min	MAX	
-20	40	20
40	100	16,5
100	120	15
120	150	12
150	200	10

#### ACCOPIAMENTO A TENUTA SUL FILETTO

Norma EN 10226-1 (ex ISO 7/1)

Filettatura gas:

**maschio conico [ designazione R ]**

**femmina cilindrica [ designazione Rp ]**

#### COUPLING WITH SEAL ON THE THREAD

EN 10226-1 (ex ISO 7/1) standard

Gas thread:

**conical male [ designation R ]**

**cylindrical female [ designation Rp ]**

#### ACCOPIAMENTO CON GUARNIZIONE PIATTA (NON A TENUTA SUL FILETTO)

Norma ISO 228

Filettatura gas:

**maschio cilindrico [ designazione G (A o B)**

**A o B = classi di tolleranza ]**

**femmina cilindrica [ designazione G ]**

#### COUPLING WITH FLAT GASKET (NOT HOLDING THE THREAD)

ISO 228 standard

Gas thread:

**cylindrical male [ designation G (A or B)**

**A or B = tolerance classes ]**

**cylindrical female [ designation G ]**