



89

A 30 30

DEVIAZIONE A Y

- Y-TEE BANDED
- Y-FITTING MIT INNENGEWINDE
- Y RACCORD
- RACOR "Y"

MATERIAL: AISI 316 / 1.4401 / 1.4408
THREAD: EN 10226-1 (ex ISO 7/1)
RATING: 150 PSI – PN10

CODE	DN	DN inch	A mm	L mm	L1 mm		
089108316	6	1/8"	17	10	17	40	10
089104316	8	1/4"	21	13	19	64	10
089308316	10	3/8"	25	14	23	100	10
089102316	15	1/2"	29	18	27	128	10
089304316	20	3/4"	35	20	32	193	10
089100316	25	1"	43	23	38	323	10
089114316	32	1 1/4"	52	28	46	485	5
089112316	40	1 1/2"	58	30	48	565	5
089200316	50	2"	71	34	57	890	1

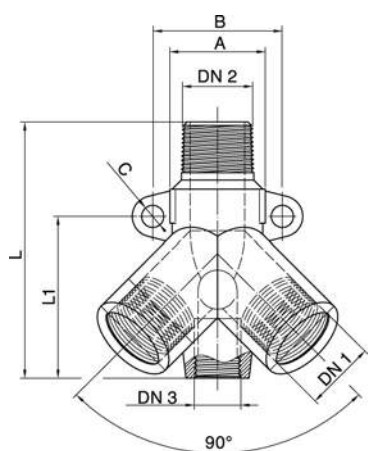



89/P

A 30 30

DEVIAZIONE A Y PER IMPIANTI ARIA COMPRESSA

- Y-TEE BANDED FOR COMPRESSED AIR SYSTEMS
- Y-FITTING MIT INNENGEWINDE FÜR DRUCKLUFT ANLAGE
- Y RACCORD POUR LES SYSTÈMES D'AIR COMPRIMÉ
- RACOR "Y" PARA INSTALACIONES DE AIRE COMPRIMIDO

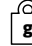
MATERIAL: AISI 316 / 1.4401 / 1.4408
THREAD: EN 10226-1 (ex ISO 7/1)
RATING: 150 PSI – PN10

CODE	DN1 inch	DN2 inch	DN3 inch	L mm	L1 mm	A mm	B mm	C mm		
089102316P	1/2"	1/2"	1/4"	75	47,5	28	38	6,5	300	5

A 30 30

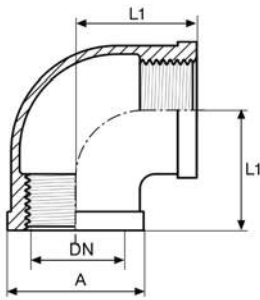

90

GOMITO 90° FF

- ELBOW 90° F/F
- WINKEL 90° I/I
- COUDE FF 90°
- CODO 90 HH

MATERIAL: AISI 316 / 1.4401 / 1.4408
THREAD: EN 10226-1 (ex ISO 7/1)
RATING: 150 PSI – PN10

CODE	DN	DN inch	A mm	L1 mm			
090108316	6	1/8"	17	19	39	10	450
090104316	8	1/4"	21,3	21	61	10	300
090308316	10	3/8"	23,5	21,3	68	10	250
090102316	15	1/2"	29	27	102	10	100
090304316	20	3/4"	36	33	164	10	50
090100316	25	1"	43	38	264	10	70
090114316	32	1"1/4	52	45	413	5	45
090112316	40	1"1/2	58	50	521	5	30
090200316	50	2"	71,5	57	808	5	15
090212316	65	2"1/2	87	69,7	1183	4	8
090300316	80	3"	99,5	77	1504	1	8
090400316	100	4"	126	98,2	2714	1	2

A 30 30

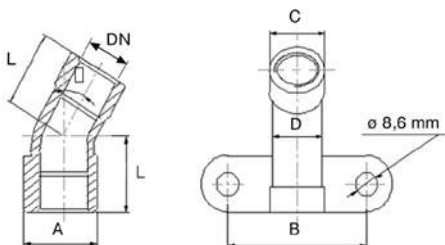

91

GOMITO FF CON FLANGIA

- WALL PLATE ELBOW F/F
- DECKENWINKEL MIT INNENGEWINDE
- COUDE FF AVEC BRIDE
- CODO PLACA

MATERIAL: AISI 316 / 1.4401 / 1.4408
THREAD: EN 10226-1 (ex ISO 7/1)
RATING: 150 PSI – PN10

CODE	DN	DN inch	degrees	L mm	A mm	B mm	C mm	D mm		
091102045	15	1/2"	45°	22,8	28,5	55	27	25	146	5
091102090	15	1/2"	90°	27,7	28,5	55	27	25	162	5

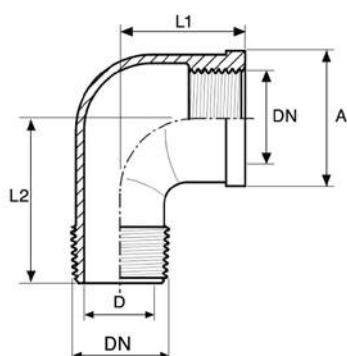

92

GOMITO 90° MF

- ELBOW 90° M/F
- WINKEL 90° I/A
- COUDE MF 90°
- CODO 90 MH

MATERIAL: AISI 316 / 1.4401 / 1.4408

THREAD: EN 10226-1 [ex ISO 7/1]

RATING: 150 PSI – PN10

CODE	DN	DN inch	A mm	L1 mm	L2 mm	D mm			
092108316	6	1/8"	17	19	25	5,5	26	10	600
092104316	8	1/4"	21	21	28,3	7,6	40	10	400
092308316	10	3/8"	25	25	32	10	73	10	200
092102316	15	1/2"	29	28	42	12,7	94	10	120
092304316	20	3/4"	35	33	50,5	17,7	167	10	60
092100316	25	1"	43	38	52	24,8	231	10	80
092114316	32	1 1/4"	52	45	60	33	429	5	45
092112316	40	1 1/2"	58,8	50	65	38	473	5	30
092200316	50	2"	71,7	58	74	48,7	760	5	15
092212316	65	2 1/2"	86,2	69	101	62	1286	4	8
092300316	80	3"	100	77	114,5	74,5	1925	1	6
092400316	100	4"	126,5	97	146,5	100	3100	1	3

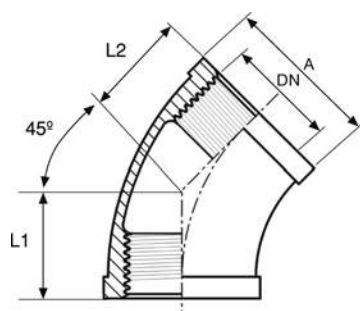

121

GOMITO 45° FF

- ELBOW 45° F/F
- WINKEL 45° I/I
- COUDE FF 45°
- CODO 45 HH

MATERIAL: AISI 316 / 1.4401 / 1.4408

THREAD: EN 10226-1 [ex ISO 7/1]

RATING: 150 PSI – PN10

CODE	DN	DN inch	A mm	L1 mm	L2 mm		
121108316	6	1/8"	18	18	18	36	10
121104316	8	1/4"	21	17	17	50	10
121308316	10	3/8"	25	20	20	87	10
121102316	15	1/2"	29,5	22	22	105	10
121304316	20	3/4"	35,6	25	25	147	10
121100316	25	1"	43	28	28	246	10
121114316	32	1 1/4"	52,4	33	33	347	5
121112316	40	1 1/2"	58	36	36	416	5
121200316	50	2"	72	43	43	673	5
121212316	65	2 1/2"	87	49	49	948	4
121300316	80	3"	100	55	55	1232	1
121400316	100	4"	125,5	64	64	3156	1

A 30 30

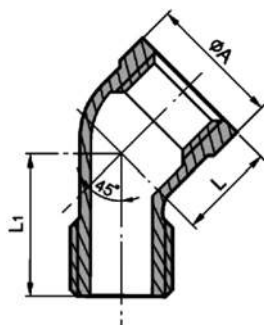

122

GOMITO 45° MF

- ELBOW 90° M/F
- WINKEL 90° I/A
- COUDE MF 90°
- CODO 90 MH

MATERIAL: AISI 316 / 1.4401 / 1.4408
THREAD: EN 10226-1 (ex ISO 7/1)
RATING: 150 PSI – PN10

CODE	DN	DN inch	A mm	L mm	L1 mm	g	
122108316	6	1/8"	17	16	21	24	10
122104316	8	1/4"	21	17	23	42	10
122308316	10	3/8"	25	19	27	63	10
122102316	15	1/2"	29	21	31	87	10
122304316	20	3/4"	35	25	36	135	10
122100316	25	1"	43	29	42	230	10
122114316	32	1 1/4"	52	34	49	360	5
122112316	40	1 1/2"	58	37	51	422	5
122200316	50	2"	71	42	59	710	5
122212316	65	2 1/2"	88	49	71	1210	4
122300316	80	3"	101	54	79	1670	2
122400316	100	4"	129	65	96	2860	1

A 30 30

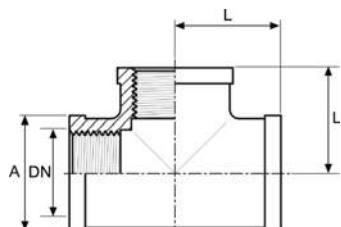

131

TEE NORMALE

- TEE
- T-STÜCK
- TEE
- TE IGUAL

MATERIAL: AISI 316 / 1.4401 / 1.4408
THREAD: EN 10226-1 (ex ISO 7/1)
RATING: 150 PSI – PN10

CODE	DN	DN inch	A mm	L mm	g		
131108316	6	1/8"	17	19	56	10	300
131104316	8	1/4"	21,3	21	82	10	200
131308316	10	3/8"	23,5	23,6	105	10	150
131102316	15	1/2"	30	28	156	10	70
131304316	20	3/4"	35	33	229	10	40
131100316	25	1"	43	38	369	10	50
131114316	32	1 1/4"	52	45	558	5	30
131112316	40	1 1/2"	58,5	50	702	5	20
131200316	50	2"	71,5	58	1082	5	15
131212316	65	2 1/2"	87	70	1517	2	8
131300316	80	3"	100	78,5	1856	2	4
131400316	100	4"	125	97	3170	1	2

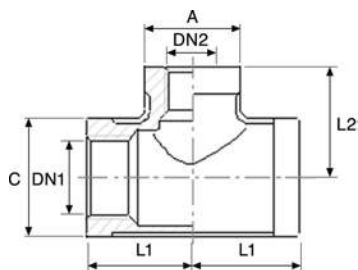

132

TEE RIDOTTO

- REDUCING TEE
- T-STÜCK MIT REDUZIERTEM ABGANG
- TEE RÉDUIT
- TE CON SALIDA REDUCIDA

MATERIAL: AISI 316 / 1.4401 / 1.4408

THREAD: EN 10226-1 (ex ISO 7/1)

RATING: 150 PSI – PN10

CODE	DN1 inch	DN2 inch	A mm	C mm	L1 mm	L2 mm	g	kg
132104108	1/4"	1/8"	17	21	18	19	66	10
132308104	3/8"	1/4"	21	23	20	22	70	10
132102308	1/2"	3/8"	23,5	29	26	25	116	10
132304102	3/4"	1/2"	30	37	30	32	230	10
132100102	1"	1/2"	30,5	44	32	33,4	307	10
132100304	1"	3/4"	35,8	44	35	35	324	10
132114102	1 1/4"	1/2"	28,8	51,4	34	38	330	5
132114304	1 1/4"	3/4"	35,8	51,4	38	40	376	5
132114100	1 1/4"	1"	43,3	51,4	40	42	426	5
132112102	1 1/2"	1/2"	28,8	57,9	35	42	420	5
132112304	1 1/2"	3/4"	35,8	57,9	38	43	467	5
132112100	1 1/2"	1"	43,3	57,9	41	45	517	5
132112114	1 1/2"	1 1/4"	51,4	57,9	45	48	579	5
132200102	2"	1/2"	28,8	71	38	48	593	5
132200304	2"	3/4"	35,8	71	41	49	662	5
132200100	2"	1"	43,3	71	44	51	740	5
132200114	2"	1 1/4"	51,4	71	48	54	785	5
132200112	2"	1 1/2"	57,9	71	52	55	872	5

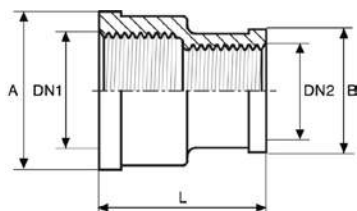

140

MANICOTTO RIDOTTO

- REDUCTION SOCKET
- REDUZIERMUFFE
- MANCHON RÉDUIT
- MANGUITO REDUCCIÓN

MATERIAL: AISI 316 / 1.4401 / 1.4408

THREAD: EN 10226-1 (ex ISO 7/1)

RATING: 150 PSI – PN10

CODE	DN1 inch	DN2 inch	A mm	B mm	L mm	g	kg
140108104	1/4"	1/8"	21,5	19	26	31	10
140308104	3/8"	1/4"	26	21,5	29	53	10
140102308	1/2"	3/8"	29	22,4	34	70	10
140304102	3/4"	1/2"	37	28,1	37	116	10
140100102	1"	1/2"	43	29,4	42	154	10
140100304	1"	3/4"	43	32	42	148	10
140114102	1 1/4"	1/2"	52	29	48	230	10
140114304	1 1/4"	3/4"	52	35	48	234	5
140114100	1 1/4"	1"	52,5	39	52	230	5
140112100	1 1/2"	1"	59	43,5	53	292	5
140112114	1 1/2"	1 1/4"	59	50	53	298	5
140200100	2"	1"	72	43	56	456	5
140200114	2"	1 1/4"	72	52	56	430	5
140200112	2"	1 1/2"	72	56,7	57	452	5

A 30 30

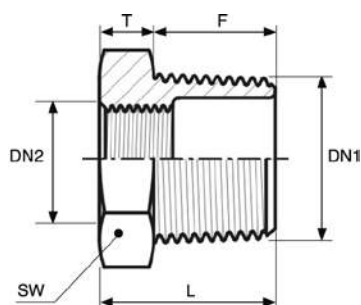

141

RIDUZIONE MF

- HEXAGONAL BUSHING M/F
- 6-KANT REDUZIERSTÜCK
- REDUCTION MF
- TUERCA REDUCCIÓN

MATERIAL: AISI 316 / 1.4401 / 1.4408
THREAD: EN 10226-1 (ex ISO 7/1)
RATING: 150 PSI – PN10

CODE	DN1 inch	DN2 inch	L mm	T mm	F mm	SW mm			
141104108	1/4"	1/8"	15,2	4,4	10,8	16	10	10	1200
141308108	3/8"	1/8"	16,5	4,1	12,4	18	19	10	800
141308104	3/8"	1/4"	16,5	4,6	11,9	18	14	10	800
141102104	1/2"	1/4"	21	5,4	15,6	26	40	10	400
141102308	1/2"	3/8"	21	5,6	15,4	26	34	10	400
141304104	3/4"	1/4"	24	6,4	17,6	30	71	10	200
141304308	3/4"	3/8"	24	6,6	17,4	30	65	10	200
141304102	3/4"	1/2"	24	6,5	17,5	30	54	10	200
141100102	1"	1/2"	27	7,3	19,7	35	99	10	150
141100304	1"	3/4"	27	7,3	19,7	35	77	10	150
141114102	1 1/4"	1/2"	30	8,1	21,9	45	197	5	80
141114304	1 1/4"	3/4"	30	8,1	21,9	45	183	5	80
141114100	1 1/4"	1"	30	8,1	21,9	45	150	5	80
141112102	1 1/2"	1/2"	38	12,2	25,8	52	312	5	60
141112304	1 1/2"	3/4"	38	12,2	25,8	52	303	5	60
141112100	1 1/2"	1"	38	12,2	25,8	52	292	5	60
141112114	1 1/2"	1 1/4"	38	12,2	25,8	52	202	5	60
141200100	2"	1"	36	11,2	24,8	63	382	5	35
141200114	2"	1 1/4"	36	11,2	24,8	63	360	5	35
141200112	2"	1 1/2"	36	11,2	24,8	63	296	5	35
141212100	2 1/2"	1"	45	14,1	30,9	81	855	5	15
141212114	2 1/2"	1 1/4"	45	14,1	30,9	81	796	5	15
141212112	2 1/2"	1 1/2"	45	14,1	30,9	81	753	5	15
141212200	2 1/2"	2"	45	14,1	30,9	81	630	5	15
141300200	3"	2"	47	14	33	95	1041	2	12
141300212	3"	2 1/2"	47	14	33	95	767	2	12
141400200	4"	2"	52	12	40	120	1993	2	8
141400212	4"	2 1/2"	52	12	40	120	1631	2	8
141400300	4"	3"	52	12	40	120	1493	2	8

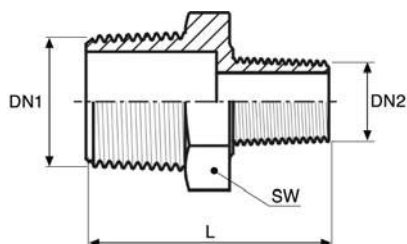

145

VITE DOPPIA RIDOTTA

- HEXAGONAL NIPPLE REDUCED
- 6-KANT DOPPELNIPPEL REDUZIERT
- MAMELON RÉDUIT
- MACHÓN REDUCIDO

MATERIAL: AISI 316 / 1.4401 / 1.4408

THREAD: EN 10226-1 (ex ISO 7/1)

RATING: 150 PSI – PN10

CODE	DN1 inch	DN2 inch	L mm	SW mm	g		
145104108	1/4"	1/8"	34	18	29	10	600
145308108	3/8"	1/8"	35	21	43	10	400
145308104	3/8"	1/4"	35,5	21	42	10	400
145102104	1/2"	1/4"	34	26	53	10	200
145102308	1/2"	3/8"	41	26	63	10	200
145304104	3/4"	1/4"	37	30	70	10	100
145304308	3/4"	3/8"	37	30	75	10	100
145304102	3/4"	1/2"	45	30	105	10	100
145100102	1"	1/2"	44,2	35	115	10	150
145100304	1"	3/4"	50	37	146	10	150
145114102	1 1/4"	1/2"	48	46	199	5	80
145114304	1 1/4"	3/4"	52	46	219	5	80
145114100	1 1/4"	1"	54	46	227	5	80
145112304	1 1/2"	3/4"	53	50	250	5	60
145112100	1 1/2"	1"	53	50	242	5	60
145112114	1 1/2"	1 1/4"	59	51,5	311	5	60
145200100	2"	1"	57	63	361	5	60
145200114	2"	1 1/4"	58	63	379	5	60
145200112	2"	1 1/2"	65,4	64	432	5	50
145212100	2 1/2"	1"	63	80	700	5	20
145212114	2 1/2"	1 1/4"	66	80	730	5	20
145212112	2 1/2"	1 1/2"	66	80	739	5	20
145212200	2 1/2"	2"	77	76,3	934	5	20
145300200	3"	2"	74	95	1069	2	12
145300212	3"	2 1/2"	84	92,5	1381	2	12
145400200	4"	2"	82	125	1754	2	4
145400212	4"	2 1/2"	82	125	1750	2	4
145400300	4"	3"	94	117,4	2200	2	4

A 30 30

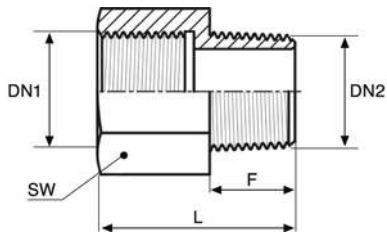

146



MANICOTTO MF (PROLUNGA)

- HEX. NEG. BUSHUNG F/M
- MUFFENNIPPEL
- MANCHON DE PROLONGEMENT
- MANGUITO HM

MATERIAL: AISI 316 / 1.4401 / 1.4408

THREAD: EN 10226-1 (ex ISO 7/1)

RATING: 150 PSI – PN10

CODE	DN1 inch	DN2 inch	L mm	F mm	SW mm		
146104108	1/4"	1/8"	27	10,8	17	23	10
146104104	1/4"	1/4"	28,5	12	17	26	10
146308104	3/8"	1/4"	30,5	11,9	21	38	10
146308308	3/8"	3/8"	31	12,3	21	43	10
146102308	1/2"	3/8"	34,5	12,3	26	64	10
146102102	1/2"	1/2"	37,5	14,6	26	73	10
146304102	3/4"	1/2"	38,5	15,6	32	102	10
146304304	3/4"	3/4"	41	17,5	32	280	10
146100304	1"	3/4"	44	17,5	38	127	10
146100100	1"	1"	46	20,1	38	300	5
146114100	1"1/4	1"	47	20	50	240	5
146114114	1"1/4	1"1/4	49	22	50	389	5
146112114	1"1/2	1"1/4	50	22,3	54	263	5
146112112	1"1/2	1"1/2	51	23,5	54	400	5
146200112	2"	1"1/2	54	23,1	68	533	5
146200200	2"	2"	57	26,5	68	537	5

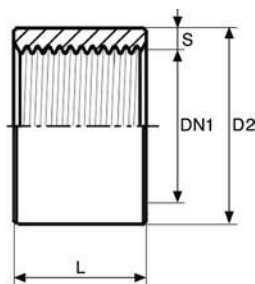
**168/316L****MEZZO MANICOTTO**

- HALF SOCKET
- MUFFE H.L.
- DEMI MANCHON
- MEDIO MANGUITO

Da tubo S.S.
From seamless pipe

MATERIAL: AISI 316L / W. 1.4404
NORM: UNI/DIN EN 10241 [ex DIN 2986]
THREAD: EN 10226-1 [ex ISO 7/1]
RATING: 150 PSI – PN10

CODE	DN	DN1 inch	D2 mm	L mm	S mm		
168108316	6	1/8"	15	8	2,35	7	10
168104316	8	1/4"	18,5	11	2,4	12	10
168308316	10	3/8"	21,3	12	2,05	14	10
168102316	15	1/2"	26,6	15	2,65	26	10
168304316	20	3/4"	31,8	17	2,55	36	10
168100316	25	1"	39,5	20	3,05	64	10
168114316	32	1 1/4"	48,3	22	3,05	88	5
168112316	40	1 1/2"	54,5	22	3,1	105	5
168200316	50	2"	66,2	26	2,95	164	5
168212316	65	2 1/2"	82	30	4,5	245	1
168300316	80	3"	95	34	3,05	312	1
168400316	100	4"	121,4	40	3,55	630	1

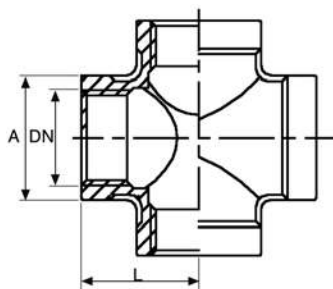
**180****CROCE FEMMINA**

- CROSS
- KREUZSTÜCK
- CROIX
- CRUZ

MATERIAL: AISI 316 / 1.4401 / 1.4408
THREAD: EN 10226-1 [ex ISO 7/1]
RATING: 150 PSI – PN10

CODE	DN	DN inch	A mm	L mm		
180108316	6	1/8"	15,2	17	38	10
180104316	8	1/4"	19,7	18,5	72	10
180308316	10	3/8"	23,3	22,9	103	10
180102316	15	1/2"	28	26,8	144	10
180304316	20	3/4"	34,8	32	249	10
180100316	25	1"	43,6	37,5	435	10
180114316	32	1 1/4"	53	45,9	701	5
180112316	40	1 1/2"	58	47,6	754	5
180200316	50	2"	71	58	1258	2
180212316	65	2 1/2"	87	69	1770	2
180300316	80	3"	99	77	2031	1
180400316	100	4"	125	97	3490	1

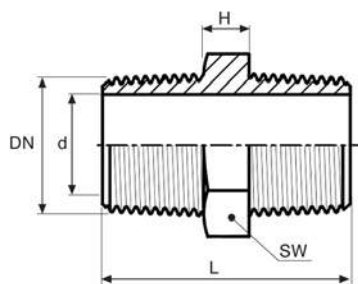

280

A 30 30

VITE DOPPIA

- HEXAGON NIPPLE
- 6-KANT DOPPELNIPPEL
- MAMELON DOUBLE
- MACHÓN DOBLE

MATERIAL: AISI 316 / 1.4401 / 1.4408

THREAD: EN 10226-1 [ex ISO 7/1]

RATING: 150 PSI – PN10

CODE	DN	DN inch	L mm	H mm	d mm	SW mm			
280108316	6	1/8"	23,6	5,9	4,3	12	12	10	700
280104316	8	1/4"	27,8	5,8	7	16	22	10	600
280308316	10	3/8"	28	3,6	9,4	19	39	10	400
280102316	15	1/2"	34	4,3	13,7	21,6	50	10	200
280304316	20	3/4"	40	7	19	30	84	10	100
280100316	25	1"	46	6,9	25,5	36	120	10	130
280114316	32	1"1/4	52,5	9,5	32	46	230	5	80
280112316	40	1"1/2	54	9,7	38,5	50	261	5	60
280200316	50	2"	62	13,2	50,2	64,5	399	5	40
280212316	65	2"1/2	70	13	63,8	79,5	698	2	18
280300316	80	3"	78,4	15	77	90	898	2	12
280400316	100	4"	94	17,6	102	120	1192	1	4

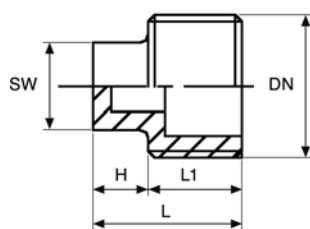

291

A 30 30

TAPPO MASCHIO TESTA QUADRA

- SQUARE PLUG
- 4-KANT STOPFEN
- BOUCHON M. CARRÉ
- TAPÓN MACHO CUADRADA

MATERIAL: AISI 316 / 1.4401 / 1.4408

THREAD: EN 10226-1 [ex ISO 7/1]

RATING: 150 PSI – PN10

CODE	DN	DN inch	L mm	L1 mm	H mm	SW mm		
291108316	6	1/8"	16,5	12,5	6,5	6 x 6	9	10
291104316	8	1/4"	20	12	8	9 x 9	17	10
291308316	10	3/8"	23	13	10	11 x 11	30	10
291102316	15	1/2"	25	15,5	9,5	13 x 13	37	10
291304316	20	3/4"	27	17	10	16 x 16	45	10
291100316	25	1"	32	20	12	20 x 20	95	10
291114316	32	1"1/4	35	22	13	24 x 24	137	5
291112316	40	1"1/2	36	22	14	25 x 25	151	5
291200316	50	2"	38	24	14	32 x 32	242	5
291212316	65	2"1/2	48	30	18	42 x 42	617	1
291300316	80	3"	52	34	18	46 x 46	913	1
291400316	100	4"	62	39,5	22,5	58 x 58	1588	1

A 30 30

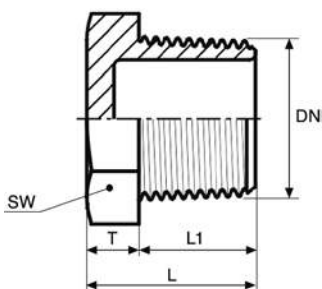

292

TAPPO MASCHIO TESTA ESAGONALE

- HEXAGONAL PLUG
- 6-KANT STOPFEN
- BOUCHON M. HEXAGONAL
- TAPÓN MACHO HEXAGONAL

MATERIAL: AISI 316 / 1.4401 / 1.4408
THREAD: EN 10226-1 (ex ISO 7/1)
RATING: 150 PSI – PN10

CODE	DN	DN inch	L mm	L1 mm	T mm	SW mm			
292108316	6	1/8"	17	8,5	8,5	12	12	10	1000
292104316	8	1/4"	17,5	12,5	5	16	20	10	800
292308316	10	3/8"	18	12	6	20	36	10	600
292102316	15	1/2"	25	16,5	8,5	24	51	10	300
292304316	20	3/4"	26	17,5	8,5	30	76	10	200
292100316	25	1"	29	20,5	8,5	38	119	10	120
292114316	32	1 1/4"	35	26,5	8,5	46	195	5	75
292112316	40	1 1/2"	38	26,5	11,5	52	297	5	60
292200316	50	2"	39	27,5	11,5	65	432	5	30
292212316	65	2 1/2"	44	30,5	13,5	81	806	3	15
292300316	80	3"	54	40,5	13,5	94	1164	2	12
292400316	100	4"	55	40,5	14,5	119	1961	2	10

A 30 30

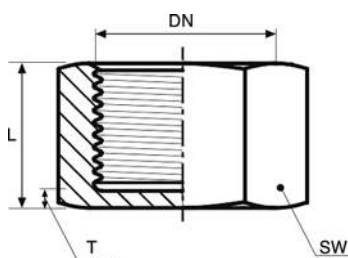

300

CALOTTA ESAGONALE

- HEXAGONAL CAP
- 6-KANT KAPPE
- BOUCHON FEMELLE HEXAGONALE
- TAPÓN HEMBRA HEXAGONAL

MATERIAL: AISI 316 / 1.4401 / 1.4408
THREAD: EN 10226-1 (ex ISO 7/1)
RATING: 150 PSI – PN10

CODE	DN	DN inch	L mm	T mm	SW mm		
300108316	6	1/8"	14	3	15	12	10
300104316	8	1/4"	18	3	18	21	10
300308316	10	3/8"	19	3	21	32	10
300102316	15	1/2"	21	3	27	58	10
300304316	20	3/4"	24	4	30	67	10
300100316	25	1"	25	4	38	116	10
300114316	32	1 1/4"	28	4,5	50	231	5
300112316	40	1 1/2"	28	4,5	55	254	5
300200316	50	2"	34	4	70	506	5
300212316	65	2 1/2"	40	6,5	92	1207	2
300300316	80	3"	45	6	109	1925	2
300400316	100	4"	50	6	132	2693	1

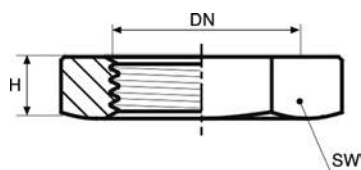

310

A 30 30

CONTRODADO

- BACK NUT
- 6-KANT GEGENMUTTER
- CONTRE ECROU
- CONTRATUERCA

MATERIAL: AISI 316 / 1.4401 / 1.4408

THREAD: ISO 228/1 (ex DIN 259)

RATING: 150 PSI – PN10

CODE	DN	DN inch	H mm	SW mm		
310108316	6	1/8"	6,2	14	18	10
310104316	8	1/4"	7	23	19	10
310308316	10	3/8"	8	26	22	10
310102316	15	1/2"	10	31	39	10
310304316	20	3/4"	11	37	56	10
310100316	25	1"	10	46	79	10
310114316	32	1 1/4"	11	55	110	5
310112316	40	1 1/2"	12	63	154	5
310200316	50	2"	13	76	227	5
310212316	65	2 1/2"	16	95	450	1
310300316	80	3"	19	105	575	1
310400316	100	4"	20	131	775	1

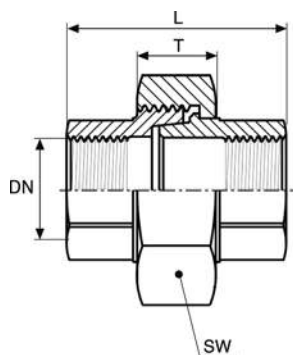

330

A 30 30

GIUNTO A 3 PEZZI FF

- UNION CONICAL F/F
- VERSCHRAUBUNG I/I
- MANCHON UNION FF CONIQUE
- ENLACE 3 PIEZAS CÓNICA

MATERIAL: AISI 316 / 1.4401 / 1.4408

THREAD: EN 10226-1 (ex ISO 7/1)

RATING: 150 PSI – PN10

CODE	DN	DN inch	L mm	T mm	SW mm		
330108316	6	1/8"	29	13,5	25	54	10
330104316	8	1/4"	37,5	13,5	30	101	10
330308316	10	3/8"	38	15,5	35	128	10
330102316	15	1/2"	42	17	42	198	10
330304316	20	3/4"	49	19	47	275	10
330100316	25	1"	48	20,5	53	314	10
330114316	32	1 1/4"	59	23	71	737	5
330112316	40	1 1/2"	65	26	77	815	5
330200316	50	2"	69	28,5	92	1221	5
330212316	65	2 1/2"	80	28,5	112	1879	2
330300316	80	3"	88	30	126	2591	1
330400316	100	4"	108	38	157	4340	1

A 30 30

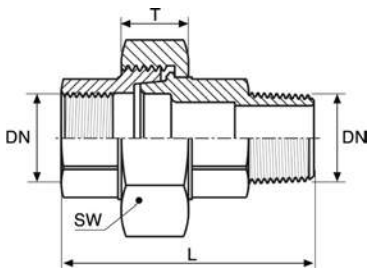

341



GIUNTO A 3 PEZZI MF

- UNION CONICAL M/F
- VERSCHRAUBUNG I/A
- MANCHON UNION MF
- ENLACE 3 PIEZAS MH CÓNICA

MATERIAL: AISI 316 / 1.4401 / 1.4408

THREAD: EN 10226-1 (ex ISO 7/1)

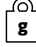
RATING: 150 PSI – PN10

CODE	DN	DN inch	L mm	T mm	SW mm		
341108316	6	1/8"	40	13,5	25	59	10
341104316	8	1/4"	50	13,5	30	108	10
341308316	10	3/8"	50	15,5	35	133	10
341102316	15	1/2"	58	17	42	230	10
341304316	20	3/4"	67	19	47	332	10
341100316	25	1"	68,3	20,5	53	403	10
341114316	32	1"1/4	83	23	71	865	5
341112316	40	1"1/2	86,3	26	78	978	5
341200316	50	2"	94	28,5	92	1509	5
341212316	65	2"1/2	113,3	28,5	112	2457	2
341300316	80	3"	127	30	126	3450	1
341400316	100	4"	154,5	38	157	5720	1

A 30 30

342

BOCCHETTONE CURVO MF



- UNION CONICAL ELBOW M/F
- WINKEL KUPPLUNG I/A
- COUDE UNION MF
- ENLACE 3 PIEZAS CURVA MH

MATERIAL: AISI 316 / 1.4401 / 1.4408

THREAD: EN 10226-1 (ex ISO 7/1)

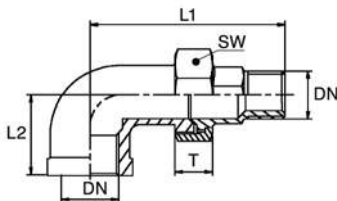
RATING: 150 PSI – PN10



CODE	DN	DN inch	L1 mm	L2 mm	T mm	SW mm		
342104316	8	1/4"	58,6	21	13,5	30	147	10
342308316	10	3/8"	61	25	15,5	35	187	10
342102316	15	1/2"	71	28	17	42	269	10
342304316	20	3/4"	78,7	33	19	47	409	10
342100316	25	1"	88,4	38	20,5	53	602	10
342114316	32	1"1/4	102,9	45	23	71	1142	5
342112316	40	1"1/2	110,3	50	26	77	1315	3
342200316	50	2"	119,4	58	28,5	92	1992	2

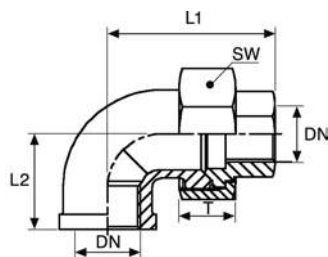

343

BOCCHETTONE CURVO FF

- UNION CONICAL ELBOW F/F
- WINKEL KUPPLUNG I/I
- COUDE UNION FF
- ENLACE 3 PIEZAS CURVA HH

MATERIAL: AISI 316 / 1.4401 / 1.4408

THREAD: EN 10226-1 [ex ISO 7/1]

RATING: 150 PSI – PN10

CODE	DN	DN inch	L1 mm	L2 mm	T mm	SW mm	g	g
343104316	8	1/4"	46,2	21	13,5	30	139	10
343308316	10	3/8"	49	25	15,5	35	164	10
343102316	15	1/2"	56	28	17	42	266	10
343304316	20	3/4"	62,7	33	19	47	364	10
343100316	25	1"	68	38	20,5	53	598	10
343114316	32	1"1/4"	79,5	45	23	71	1009	5
343112316	40	1"1/2"	88	50	26	78	1181	5
343200316	50	2"	93,8	58	28,5	92	1847	2

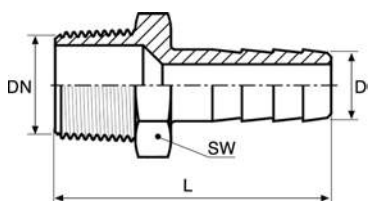

344

PORTAGOMMA M

- HOSE NIPPLE
- SCHLAUCHNIPPEL
- TETON M
- ENTRONQUE MANGUERA

MATERIAL: AISI 316 / 1.4401 / 1.4408

THREAD: EN 10226-1 [ex ISO 7/1]

RATING: 150 PSI – PN10

CODE	DN	DN inch	D mm	L mm	SW mm	g	g
344108316	6	1/8"	7	45	12,5	15	10
344104316	8	1/4"	9	47	16,5	31	10
344308316	10	3/8"	11	55	20	41	10
344102316	15	1/2"	13	64	23,5	71	10
344304316	20	3/4"	16	68	31	118	10
344100316	25	1"	25	71	38,5	235	5
344114316	32	1"1/4"	33	80	46	267	5
344112316	40	1"1/2"	39	95	52	428	5
344200316	50	2"	51	105	62	666	5

A 30 30

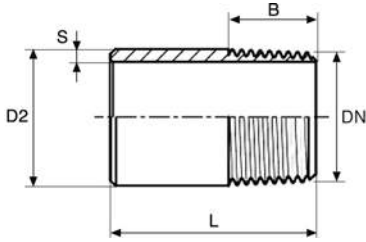

600/304L

TRONCHETTO DA TUBO SALDATO

- WELDING NIPPLE
- ANSCHWEISSENDE
- DEMI MAMELON
- ENTRONQUE TUBO SOLDADO

MATERIAL: AISI 304L / W. 1.4307
THREAD: EN 10226-1 (ex ISO 7/1)
RATING: 150 PSI – PN10

CODE	DN	DN inch	D2 mm	S mm	L mm	B mm			
600108304	6	1/8"	10,3	2	30	10	11	10	500
600104304	8	1/4"	13,7	2,3	30	10	15	10	600
600308304	10	3/8"	17,2	2,3	30	10	23	10	400
600102304	15	1/2"	21,3	2,6	35	13	33	10	400
600304304	20	3/4"	26,9	2,6	40	15	52	10	200
600100304	25	1"	33,7	3,2	40	17	77	10	200
600114304	32	1 1/4"	42,4	3,2	50	19	120	10	100
600112304	40	1 1/2"	48,3	3,2	50	19	150	5	100
600200304	50	2"	60,3	3,6	50	23	200	5	50
600212304	65	2 1/2"	76,1	3,6	60	27	310	6	36
600300304	80	3"	88,9	4	70	30	470	6	6
600400304	100	4"	114,3	4,5	80	36	760	6	6

A 30 30

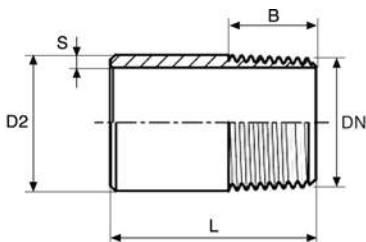

600/316L

TRONCHETTO DA TUBO SALDATO

- WELDING NIPPLE
- ANSCHWEISSENDE
- DEMI MAMELON
- ENTRONQUE TUBO SOLDADO

MATERIAL: AISI 316L / W. 1.4404
THREAD: EN 10226-1 (ex ISO 7/1)
RATING: 150 PSI – PN10

CODE	DN	DN inch	D2 mm	S mm	L mm	B mm			
600108316	6	1/8"	10,3	2	30	10	11	10	500
600104316	8	1/4"	13,7	2,3	30	10	15	10	600
600308316	10	3/8"	17,2	2,3	30	10	23	10	400
600102316	15	1/2"	21,3	2,6	35	13	33	10	400
600304316	20	3/4"	26,9	2,6	40	15	52	10	200
600100316	25	1"	33,7	3,2	40	17	77	10	200
600114316	32	1 1/4"	42,4	3,2	50	19	120	10	100
600112316	40	1 1/2"	48,3	3,2	50	19	150	5	100
600200316	50	2"	60,3	3,6	50	23	200	5	50
600212316	65	2 1/2"	76,1	3,6	60	27	310	6	36
600300316	80	3"	88,9	4	70	30	470	6	6
600400316	100	4"	114,3	4,5	80	36	760	6	6

INFORMAZIONI TECNICHE

Technical info

I raccordi filettati IN OX sono usati per tipici impianti di trasporto acqua, aria, gas, olio e vapore.

La "Classe" di prodotto dei raccordi inox è 150 psi.

Il range di temperatura di utilizzo è -20 / +200 °C, mentre la pressione di esercizio è dipendente dalla temperatura secondo tabella seguente (dati ricavati dagli standards ISO 4144 e ANSI/MSS SP-114)

Threaded fittings are used for typical plants to transport water, air, gas, oil and steam.

The "class" product of stainless steel fittings is 150 psi.

The range of operating temperature is -20 / + 200 ° C while the pressure depend from temperature in according to the following table [data obtained from the standards ISO 4144 and ANSI / MSS SP-114].

T (C°)		P (bar)
Min	MAX	
-20	40	20
40	100	16,5
100	120	15
120	150	12
150	200	10

ACCOPIAMENTO A TENUTA SUL FILETTO

Norma EN 10226-1 (ex ISO 7/1)

Filettatura gas:

maschio conico [designazione R]

femmina cilindrica [designazione Rp]

COUPLING WITH SEAL ON THE THREAD

EN 10226-1 (ex ISO 7/1) standard

Gas thread:

conical male [designation R]

cylindrical female [designation Rp]

ACCOPIAMENTO CON GUARNIZIONE PIATTA (NON A TENUTA SUL FILETTO)

Norma ISO 228

Filettatura gas:

maschio cilindrico [designazione G (A o B)

A o B = classi di tolleranza]

femmina cilindrica [designazione G]

COUPLING WITH FLAT GASKET (NOT HOLDING THE THREAD)

ISO 228 standard

Gas thread:

cylindrical male [designation G (A or B)

A or B = tolerance classes]

cylindrical female [designation G]