







## Certificazioni / Certifications

		QUALITY ASSURANCE SYSTEM IN ACCORDANCE WITH PRESSURE EQUIPMENT DIRECTIVE 97/23/EC	DRG-0036-QS-W 192/2003/MUC
		RACCORDERIE METALLICHE S.P.A. ÁLTAL GYÁRTOTT ACÉL HEGESZTHETŐ IDOMOK, CSÓÍVEK, MENETES VÉGEK	A-2139/2012
		CARBON STEEL WELD FITTINGS	POCC IT.AB51.H01616

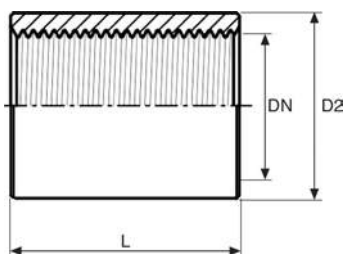

## 268/Z

**R 10 11**

### MANICOTTO ZINCATO



- GALVANIZED SOCKET
- MUFFE G. L. VERZINKT
- MANCHON GALVANISÉ
- MANGUITO GALVANIZADO

**TYPE:** International Nr. 16

**MATERIAL:** CB4FFKD ( $\varnothing < 1''$ )  
P235TR1 - S235 (R.St.37.0) ( $\varnothing \geq 1''$ )

**NORM:** UNI / DIN EN 10241 (ex DIN 2986)

**THREAD:** EN 10226-1 (ex ISO 7/1)

CODE	DN	DN inch	D2 mm	L min mm			
268108001*	6	1/8"	14	17	12	200	-
268104001*	8	1/4"	18,5	25	23	200	-
268308001*	10	3/8"	21,3	26	33	150	-
268102001*	15	1/2"	26,4	34	63	150	14400
268304001*	20	3/4"	31,8	36	80	150	8400
268100001	25	1"	39,5	43	142	100	5600
268114001	32	1 1/4"	48,3	48	189	50	2800
268112001	40	1 1/2"	54,5	48	220	40	2240
268200001	50	2"	66,3	56	320	25	1400
268212001	65	2 1/2"	82	65	530	6	-
268300001	80	3"	95	71	680	6	-
268400001	100	4"	122	83	1100	6	-
268500001	125	5"	147	92	1531	4	-
268600001	150	6"	174	92	2212	2	-

[\*] Stampati Cold formed Kalt verformt Matrices Estampados

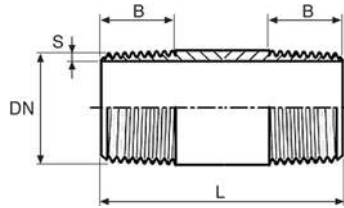



## 530/Z

VITE DI ALLUNGAMENTO  
BARILOTTO ZINCATO

- GALVANISED BARREL NIPPLE
- ROHRDOPPELNIPPEL VERZINKT
- MAMELON GALVANISÉ
- CARRETE DE PROLONGACION GALVANIZADO

**TYPE:** International Nr. 23  
**MATERIAL:** P235TR1 - S235 (R.St.37.0)  
**NORM:** UNI / DIN EN 10241 (ex DIN 2982)  
**THREAD:** EN 10226-1 (ex ISO 7/1)  
**GALVANIZATION:** EN 10240 A1

CODE	DN	DN inch	DN mm	L mm	B mm	S mm		
530308043	10	3/8"	17	40	11	2	38	10
530102043	15	1/2"	21,2		14	2,3	50	10
530304043	20	3/4"	26,9		16	2,3	63	10
530100043	25	1"	33,7		18	2,9	91	20
530114043	32	1"1/4	42,4		20	2,9	128	20
530112043	40	1"1/2	48,3		22	2,9	147	20
530200043	50	2"	60,3		24	3,2	205	20
530308053	10	3/8"	17	50	11	2	47	10
530102053	15	1/2"	21,2		14	2,3	61	10
530304053	20	3/4"	26,9		16	2,3	78	10
530100053	25	1"	33,7		18	2,9	112	20
530114053	32	1"1/4	42,4		20	2,9	156	20
530112053	40	1"1/2	48,3		22	2,9	179	20
530200053	50	2"	60,3		24	3,2	251	20
530308063	10	3/8"	17	60	11	2	55	10
530102063	15	1/2"	21,2		14	2,3	72	10
530304063	20	3/4"	26,9		16	2,3	92	10
530100063	25	1"	33,7		18	2,9	132	20
530114063	32	1"1/4	42,4		20	2,9	185	20
530112063	40	1"1/2	48,3		22	2,9	212	20
530200063	50	2"	60,3		60	24	3,2	296
530308073	10	3/8"	17	70	11	2	64	10
530102073	15	1/2"	21,2		14	2,3	82	30
530304073	20	3/4"	26,9		16	2,3	106	30
530100073	25	1"	33,7		18	2,9	152	20
530114073	32	1"1/4	42,4		20	2,9	213	20
530112073	40	1"1/2	48,3		22	2,9	244	20
530200073	50	2"	60,3		24	3,2	342	20
530308083	10	3/8"	17	80	11	2	72	10
530102083	15	1/2"	21,2		14	2,3	93	30
530304083	20	3/4"	26,9		16	2,3	120	30
530100083	25	1"	33,7		18	2,9	172	20
530114083	32	1"1/4	42,4		20	2,9	241	16
530112083	40	1"1/2	48,3		22	2,9	277	16
530200083	50	2"	60,3		24	3,2	388	12
530212083	65	2"1/2	76,1	25	3,6	553	10	
530300083	80	3"	88,9	30	3,6	650	6	
530400083	100	4"	114,3	35	4,2	1028	6	

R 10 13

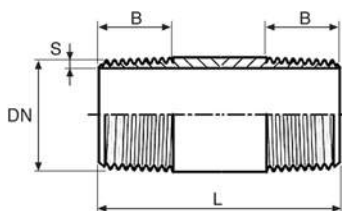



## 530/Z

VITE DI ALLUNGAMENTO  
BARILOTTO ZINCATO

- GALVANISED BARREL NIPPLE
- ROHRDOPPELNIPPEL VERZINKT
- MAMELON GALVANISÉ
- CARRETE DE PROLONGACION GALVANIZADO

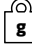
**TYPE:** International Nr. 23  
**MATERIAL:** P235TR1 - S235 (R.St.37.0)  
**NORM:** UNI / DIN EN 10241 (ex DIN 2982)  
**THREAD:** EN 10226-1 (ex ISO 7/1)  
**GALVANIZATION:** EN 10240 A1

CODE	DN	DN inch	DN mm	L mm	B mm	S mm			
530102093	15	1/2"	21,2	90	14	2,3	104	30	
530304093	20	3/4"	26,9		16	2,3	134	30	
530100093	25	1"	33,7		18	2,9	193	20	
530114093	32	1 1/4"	42,4		20	2,9	270	16	
530112093	40	1 1/2"	48,3		22	2,9	310	16	
530200093	50	2"	60,3		24	3,2	433	12	
530308103	10	3/8"	17		11	2	89	30	
530102103	15	1/2"	21,2	100	14	2,3	116	30	
530304103	20	3/4"	26,9		16	2,3	148	30	
530100103	25	1"	33,7		18	2,9	213	20	
530114103	32	1 1/4"	42,4		20	2,9	298	16	
530112103	40	1 1/2"	48,3		22	2,9	342	16	
530200103	50	2"	60,3		24	3,2	479	12	
530212103	65	2 1/2"	76,1		25	3,6	684	10	
530300103	80	3"	88,9	30	3,6	803	6		
530400103	100	4"	114,3	35	4,2	1271	6		
530102113	15	1/2"	21,2	110	14	2,3	127	15	
530304113	20	3/4"	26,9		16	2,3	162	15	
530100113	25	1"	33,7		18	2,9	233	10	
530308123	10	3/8"	17		11	2	106	15	
530102123	15	1/2"	21,2		14	2,3	138	15	
530304123	20	3/4"	26,9		16	2,3	176	15	
530100123	25	1"	33,7		18	2,9	254	10	
530114123	32	1 1/4"	42,4	120	20	2,9	355	8	
530112123	40	1 1/2"	48,3		22	2,9	408	8	
530200123	50	2"	60,3		24	3,2	570	6	
530212123	65	2 1/2"	76,1		25	3,6	814	5	
530300123	80	3"	88,9		30	3,6	918	4	
530400123	100	4"	114,3		35	4,2	1513	6	
530102133	15	1/2"	21,2		130	14	2,3	149	15
530304133	20	3/4"	26,9	16		2,3	190	15	
530102143	15	1/2"	21,2	14		2,3	160	15	
530304143	20	3/4"	26,9	16		2,3	204	15	
530100143	25	1"	33,7	18		2,9	294	10	
530114143	32	1 1/4"	42,4	140		20	2,9	412	8
530112143	40	1 1/2"	48,3			22	2,9	473	8
530200143	50	2"	60,3		24	3,2	661	6	

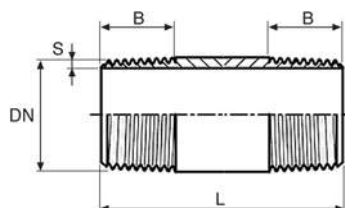

## 530/Z

VITE DI ALLUNGAMENTO  
BARILOTTO ZINCATO

- GALVANISED BARREL NIPPLE
- ROHRDOPPELNIPPEL VERZINKT
- MAMELON GALVANISÉ
- CARRETE DE PROLONGACION GALVANIZADO

**TYPE:** International Nr. 23  
**MATERIAL:** P235TR1 - S235 (R.St.37.0)  
**NORM:** UNI / DIN EN 10241 (ex DIN 2982)  
**THREAD:** EN 10226-1 (ex ISO 7/1)  
**GALVANIZATION:** EN 10240 A1

CODE	DN	DN inch	DN mm	L mm	B mm	S mm		
530308153	10	3/8"	17	150	11	2	132	15
530102153	15	1/2"	21,2		14	2,3	171	15
530304153	20	3/4"	26,9		16	2,3	219	15
530100153	25	1"	33,7		18	2,9	315	10
530114153	32	1"1/4	42,4		20	2,9	440	8
530112153	40	1"1/2	48,3		22	2,9	505	8
530200153	50	2"	60,3		24	3,2	707	6
530212153	65	2"1/2	76,1		25	3,6	1009	5
530300153	80	3"	88,9		30	3,6	1186	4
530400153	100	4"	114,3		35	4,2	1876	6
530102163	15	1/2"	21,2	160	14	2,3	182	15
530304163	20	3/4"	26,9		16	2,3	233	15
530100163	25	1"	33,7		18	2,9	355	10
530114163	32	1"1/4	42,4		20	2,9	468	8
530112163	40	1"1/2	48,3		22	2,9	538	8
530200163	50	2"	60,3		24	3,2	752	6
530308183	10	3/8"	17	180	11	2	157	15
530102183	15	1/2"	21,2		14	2,3	203	15
530304183	20	3/4"	26,9		16	2,3	261	15
530100183	25	1"	33,7		18	2,9	376	10
530114183	32	1"1/4	42,4		20	2,9	525	8
530112183	40	1"1/2	48,3		22	2,9	603	8
530200183	50	2"	60,3		24	3,2	844	6
530212183	65	2"1/2	76,1		25	3,6	1204	5
530300183	80	3"	88,9		30	3,6	1415	6
530400183	100	4"	114,3		35	4,2	2239	6
530308203	10	3/8"	17	200	11	2	174	15
530102203	15	1/2"	21,2		14	2,3	225	15
530304203	20	3/4"	26,9		16	2,3	289	15
530100203	25	1"	33,7		18	2,9	416	10
530114203	32	1"1/4	42,4		20	2,9	582	8
530112203	40	1"1/2	48,3		22	2,9	668	8
530200203	50	2"	60,3		24	3,2	935	6
530212203	65	2"1/2	76,1		25	3,6	1335	5
530300203	80	3"	88,9		30	3,6	1568	4
530400203	100	4"	114,3		35	4,2	2481	6
530308253	10	3/8"	17	250	11	2	217	15
530102253	15	1/2"	21,2		14	2,3	281	15
530304253	20	3/4"	26,9		16	2,3	360	15
530100253	25	1"	33,7		18	2,9	518	10
530114253	32	1"1/4	42,4		20	2,9	724	8

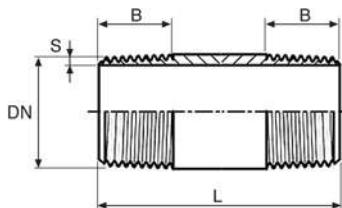

## 530/Z

### VITE DI ALLUNGAMENTO BARILOTTO ZINCATO

- GALVANISED BARREL NIPPLE
- ROHRDOPPELNIPPEL VERZINKT
- MAMELON GALVANISÉ
- CARRETE DE PROLONGACION GALVANIZADO

**TYPE:** International Nr. 23  
**MATERIAL:** P235TR1 - S235 (R.St.37,0)  
**NORM:** UNI / DIN EN 10241 (ex DIN 2982)  
**THREAD:** EN 10226-1 (ex ISO 7/1)  
**GALVANIZATION:** EN 10240 A1

CODE	DN	DN inch	DN mm	L mm	B mm	S mm			
530112253	40	1 1/2	48,3	250	22	2,9	831	8	
530200253	50	2"	60,3		24	3,2	1163	6	
530212253	65	2 1/2	76,1		25	3,6	1660	5	
530300253	80	3"	88,9		30	3,6	1951	4	
530400253	100	4"	114,3		35	4,2	3086	4	
530308303	10	3/8"	17		300	11	2	259	15
530102303	15	1/2"	21,2			14	2,3	336	15
530304303	20	3/4"	26,9			16	2,3	430	15
530100303	25	1"	33,7			18	2,9	619	10
530114303	32	1 1/4	42,4			20	2,9	866	8
530112303	40	1 1/2	48,3	22		2,9	994	8	
530200303	50	2"	60,3	24		3,2	1391	6	
530212303	65	2 1/2	76,1	25		3,6	1953	5	
530300303	80	3"	88,9	30		3,6	2666	4	
530400303	100	4"	114,3	35		4,2	3691	4	
530308403	10	3/8"	17	400	11	2	330	15	
530102403	15	1/2"	21,2		14	2,3	450	10	
530304403	20	3/4"	26,9		16	2,3	590	10	
530100403	25	1"	33,7		18	2,9	826	5	
530114403	32	1 1/4	42,4		20	2,9	1270	5	
530112403	40	1 1/2	48,3		22	2,9	1330	5	
530200403	50	2"	60,3		24	3,2	1910	3	
530212403	65	2 1/2	76,1		25	3,6	2400	4	
530300403	80	3"	88,9		30	3,6	2808	4	
530400403	100	4"	114,3		35	4,2	4550	3	
530308503	10	3/8"	17	500	11	2	420	15	
530102503	15	1/2"	21,2		14	2,3	555	10	
530304503	20	3/4"	26,9		16	2,3	740	10	
530100503	25	1"	33,7		18	2,9	1033	5	
530114503	32	1 1/4	42,4		20	2,9	1585	5	
530112503	40	1 1/2	48,3		22	2,9	1660	5	
530200503	50	2"	60,3		24	3,2	2384	3	
530212503	65	2 1/2	76,1		25	3,6	3320	4	
530300503	80	3"	88,9		30	3,6	3902	4	
530400503	100	4"	114,3		35	4,2	6172	3	
530102603	15	1/2"	21,2	600	14	2,3	680	10	
530304603	20	3/4"	26,9		16	2,3	860	10	
530100603	25	1"	33,7		18	2,9	1240	5	

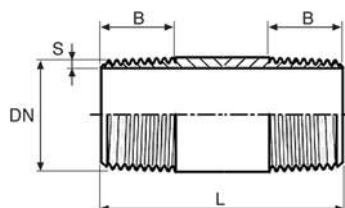

## 530/Z

VITE DI ALLUNGAMENTO  
BARILOTTO ZINCATO

- GALVANISED BARREL NIPPLE
- ROHRDOPPELNIPPEL VERZINKT
- MAMELON GALVANISÉ
- CARRETE DE PROLONGACION GALVANIZADO

**TYPE:** International Nr. 23  
**MATERIAL:** P235TR1 - S235 (R.St.37.0)  
**NORM:** UNI / DIN EN 10241 (ex DIN 2982)  
**THREAD:** EN 10226-1 (ex ISO 7/1)  
**GALVANIZATION:** EN 10240 A1

CODE	DN	DN inch	DN mm	L mm	B mm	S mm		
530102703	15	1/2"	21,2		14	2,3	790	10
530304703	20	3/4"	26,9	700	16	2,3	1020	10
530100703	25	1"	33,7		18	2,9	1550	5
530102803	15	1/2"	21,2		14	2,3	900	10
530304803	20	3/4"	26,9	800	16	2,3	1180	10
530100803	25	1"	33,7		16	2,9	1865	5
5301021003	15	1/2"	21,2		14	2,3	1110	10
5303041003	20	3/4"	26,9	1000	16	2,3	1480	10
5301001003	25	1"	33,7		18	2,9	2325	5
5301021503	15	1/2"	21,2		14	2,3	1646	10
5303041503	20	3/4"	26,9	1500	16	2,3	2200	10
5301001503	25	1"	33,7		18	2,9	3200	5
5301022003	15	1/2"	21,2		14	2,3	2257	10
5303042003	20	3/4"	26,9	2000	16	2,3	2800	10
5301002003	25	1"	33,7		18	2,9	4528	5

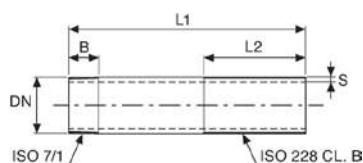

## 532

VITE DI ALLUNGAMENTO  
CONICA-CILINDRICA, ZINCATA, SCORREVOLE

- SLIDING BARREL NIPPLE
- LANGEGEWINDE VERZINKT
- MAMELON GALVANISÉ AVEC FILETAGE CONIQUE ET CYLINDRIQUE
- CARRETE DE PROLONGACION CONICO CILINDRICO GALVANIZADO

**TYPE:** International Nr. 4/b  
**MATERIAL:** P235TR1 - S235 (R.St.37.0)  
**NORM:** DIN 2981  
**THREAD:** vedi disegno/see drawing  
**GALVANIZATION:** EN 10240 A1

CODE	DN	DN inch	DN mm	S mm	L1 mm	L2 min mm	B mm		
532308100	10	3/8"	17,2	2	100	40	11	61	30
532102100	15	1/2"	21,2	2,3	100	50	14	85	30
532304120	20	3/4"	26,9	2,3	120	55	16	136	15
532100140	25	1"	33,7	2,9	140	60	18	230	10
532114150	32	1 1/4"	42,4	2,9	150	70	20	320	8
532112150	40	1 1/2"	48,3	2,9	150	70	22	407	8
532200170	50	2"	60,3	3,2	170	81	24	680	6

R1014

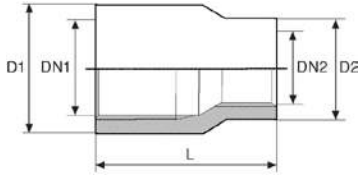

240

## MANICOTTO RIDOTTO FF ZINCATO

- GALVANIZED REDUCTION SOCKET
- REDUZIERMUFFE VERZINKT
- MANCHON REDUIT GALVANISÉ
- MANGUITO REDUCCIÓN GALVANIZADO

**TYPE:** International Nr. 17  
**NORM:** UNI / DIN EN 10241 (ex DIN 2982)  
**THREAD:** EN 10226-1 (ex ISO 7/1)

CODE	DN1	DN2	DN1 inch	DN2 inch	D1 mm	D2 mm	L mm			
240104108	8	6	1/4"	1/8"	18,5	15	24	35	10*	200
240308104	10	8	3/8"	1/4"	20	18	24	21	10	200*
240102104	15	8	1/2"	1/4"	24	18	24	37	10*	200
240308102	15	10	1/2"	3/8"	24**	21	24	27	10	200*
240304308	20	10	3/4"	3/8"	30	22	25	43	10*	100
240102304	20	15	3/4"	1/2"	30	26	25	44	10	100*
240100102	25	15	1"	1/2"	38	26	25	72	10*	100
240304100	25	20	1"	3/4"	38	32,5	25	74	10*	100
240114100	32	25	1 1/4"	1"	46*	42	32	102	10*	50

(\*) unità minima di vendita/minimum selling quantity

(\*\*) profilo esagonale / hexagonal profile

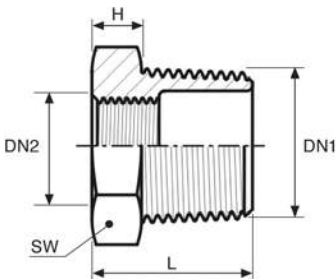

241

## RIDUZIONE MF ZINCATO

- GALVANIZED REDUCING BUSH M/F
- 6-KANT REDUZIERSTÜCK VERZINKT
- REDUCTION MF GALVANISÉ
- TUERCA REDUCCIÓN GALVANIZADO

**TYPE:** International Nr. 33  
**NORM:** UNI / DIN EN 10241 (ex DIN 2982)  
**THREAD:** EN 10226-1 (ex ISO 7/1)

R1014

CODE	DN1	DN2	DN1 x DN2 inch	L min mm	H mm	SW mm			
241104184	8	6	1/4" x 1/8"	15	5,5	14	12	10	100*
241308184	10	6	3/8" x 1/8"	17	5	19	20	10*	100
241308144	10	8	3/8" x 1/4"	17	5	19	16	10	200*
241102184	15	6	1/2" x 1/8"	22,5	6	22	32	10*	100
241102144	15	8	1/2" x 1/4"	22,5	6	22	28	10	200*
241102384	15	10	1/2" x 3/8"	21	6	22	21	10	200*
241304184	20	6	3/4" x 1/8"	17	6	27	62	10*	100
241304144	20	8	3/4" x 1/4"	24,5	6	30	55	10*	100
241304384	20	10	3/4" x 3/8"	24,5	6	30	44	10	100*
241304124	20	15	3/4" x 1/2"	24	6	30	46	10	100*
241100384	25	10	1" x 3/8"	20	6,5	34	77	10*	100
241100124	25	15	1" x 1/2"	20	6,5	34	71	10	100*
241100344	25	20	1" x 3/4"	20	6,5	34	70	5	100*
241114104	32	25	1 1/4" x 1"	23	7,5	42	88	5	25*
241112144	40	32	1 1/2" x 1 1/4"	23	7,5	48	86	5	25*
241200104	50	25	2" x 1"	26	8	60	318	5*	25
241200144	50	32	2" x 1 1/4"	26	8	60	260	5*	25
241200124	50	40	2" x 1 1/2"	26	8	60	198	5*	25

(\*) unità minima di vendita/minimum selling quantity

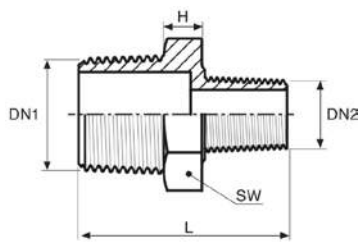

## 245

R1014

## VITE DOPPIA RIDOTTA ZINCATA

- GALVANIZED HEXAGON NIPPLE REDUCED
- 6-KANT DOPPELNIPPEL REDUZIERT VERZINKT
- MAMELON REDUIT GALVANISÉ
- MACHÓN REDUCIDO GALVANIZADO

**TYPE:** International Nr. 34  
**NORM:** UNI / DIN EN 10241 [ex DIN 2982]  
**THREAD:** EN 10226-1 [ex ISO 7/1]

CODE	DN1	DN2	DN1 x DN2 inch	L min mm	Tol L mm	H mm	SW mm			
245104184	8	6	1/4" x 1/8"	25	± 0,5	4,5	14	13	10*	100
245308184	10	6	3/8" x 1/8"	26	± 0,5	5	17	18	10*	100
245308144	10	8	3/8" x 1/4"	28	± 0,5	6	19	18	10	200*
245102184	15	6	1/2" x 1/8"	27	± 0,5	5	21	43	10*	100
245102144	15	8	1/2" x 1/4"	34	± 0,5	6,5	22	35	10	200*
245102384	15	10	1/2" x 3/8"	34	± 0,5	6,5	22	35	10	100*
245304144	20	8	3/4" x 1/4"	28	± 1	5,5	27	70	10*	100
245304384	20	10	3/4" x 3/8"	28	± 1	5,5	27	50	10*	100
245304124	20	15	3/4" x 1/2"	29	± 1	5,5	27	50	10	100*
245100124	25	15	1" x 1/2"	31	± 1	6	34	80	10*	100
245100344	25	20	1" x 3/4"	32	± 1	6	34	80	10	50*
245114104	32	25	1 1/4" x 1"	35	± 1	7,5	42	120	5	25*
245112144	40	32	1 1/2" x 1 1/4"	38	± 1	7,5	50	200	5*	25
245200104	50	25	2" x 1"	41	± 1	8	60	300	5*	25
245200144	50	32	2" x 1 1/4"	41	± 1	8	60	220	5*	25
245200124	50	40	2" x 1 1/2"	41	± 1	8	60	250	5*	25

[\*] unità minima di vendita/minimum selling quantity

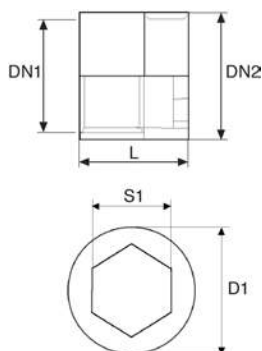

## 246/A

R1014

## MANICOTTO RIDOTTO FM (PROLUNGA RIDOTTA) MM 15 ZINCATO

- GALVANIZED F/M REDUCING SOCKET
- REDUZIERMUFFE I/A VERZINKT
- MANCHON REDUIT FM DE PROLONGEMENT GALVANISÉ
- MANGUITO UNION REDUCIDO HM GALVANIZADO

**THREAD:** ISO 228/1 [ex DIN 259]

CODE	DN1	DN2	DN1 inch	DN2 inch	D1 mm	L mm	S1 mm			
246381201	10	15	3/8"	1/2"	20	24	11	23	10*	100
246123401	15	20	1/2"	3/4"	25	24	14	39	10*	100
246341100	20	10	3/4"	1"	32	24	19	54	10*	100

[\*] unità minima di vendita/minimum selling quantity



R1014

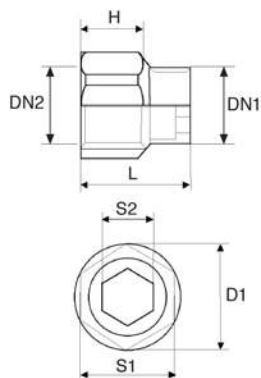

246

**MANICOTTO RIDOTTO MF (PROLUNGA RIDOTTA)  
MM 15 ZINCATA**

- GALVANIZED M/F REDUCING SOCKET
- REDUZIERMUFFE A/I VERZINKT
- MANCHON REDUIT MF DE PROLONGEMENT GALVANISÉ
- MANGUITO UNION REDUCIDO MH GALVANIZADO

**THREAD:** ISO 228/1 (ex DIN 259)

CODE	DN1	DN2	DN1 inch	DN2 inch	D1 mm	S1 mm	S2 mm	H mm	L mm			
246104108	8	6	1/4"	1/8"	18	-	-	14	24	19	10*	100
246104308	8	10	1/4"	3/8"	20	-	-	14	25	20	10	100*
246308102	10	15	3/8"	1/2"	25	24	9	15	25	30	10	200*
246308304	10	20	3/8"	3/4"	30	-	9	14	24	36	10*	200
246102304	15	20	1/2"	3/4"	30	-	12	15	26	39	10	100*
246102100	15	25	1/2"	1"	38	-	12	15	25	60	10*	100
246304100	20	25	3/4"	1"	38	-	14	15	26	68	10	100*
246100114	25	32	1"	1 1/4"	53	46	-	18	33	160	10*	50

(\*) unità minima di vendita/minimum selling quantity

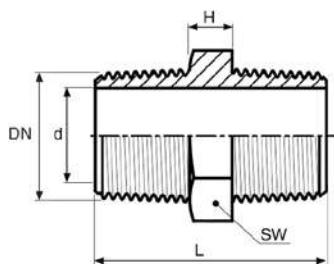

280

**VITE DOPPIA ZINCATA**

- GALVANIZED HEXAGON NIPPLE
- 6-KANT DOPPELNIPPEL VERZINKT
- MAMELON DOUBLE GALVANISÉ
- MACHÓN DOBLE GALVANIZADO

**TYPE:** International Nr. 34  
**NORM:** UNI / DIN EN 10241 (ex DIN 2982)  
**THREAD:** EN 10226-1 (ex ISO 7/1)

CODE	DN	DN inch	L mm	SW mm	H mm	d mm			
280108004	6	1/8"	24	14	4,5	4,5÷6	15	10*	100
280104004	8	1/4"	24	14	4,5	6,5÷8	17	10	200*
280308004	10	3/8"	28	20	5	8,5÷12	25	10	200*
280102004	15	1/2"	33,5	22	5,5	11,5÷14	41	10	100*
280304004	20	3/4"	40	32	6	18÷21	70	10	50*
280100004	25	1"	33	34	6,5	24÷26	90	10	50*
280114004	32	1 1/4"	37	42	7,5	30÷33	95	10*	50
280112004	40	1 1/2"	39,5	50	7,5	37÷39	150	5*	25
280200004	50	2"	42	60	8	48÷51	190	5*	25

(\*) unità minima di vendita/minimum selling quantity

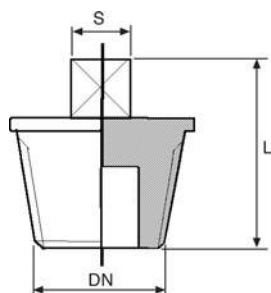

290



R1014

### TAPPO MASCHIO CON BORDO, TESTA QUADRA ZINCATO

- GALVANIZED BEADED PLUG
- 4-KANT STOPFEN MIT RAND VERZINKT
- BOUCHON MALE AVEC BOURRELET À TÊTE CARRÉ GALVANISÉ
- TAPÓN MACHO CON REBORDE GALVANIZADO

**NORM:** UNI / DIN EN 10241 (ex DIN 2982)

**THREAD:** EN 10226-1 (ex ISO 7/1)

CODE	DN	DN inch	S mm	L mm			
290108001	6	1/8"	7	14	7	10	100*
290104001	8	1/4"	9	18	14	10	100*
290308001	10	3/8"	10	20	23	10	200*
290102001	15	1/2"	12	24	40	10	200*
290304001	20	3/4"	17	27	74	10	100*
290100001	25	1"	19	33	145	10	100*

[\*] unità minima di vendita/minimum selling quantity

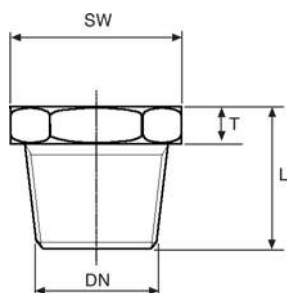

292



R1014

### TAPPO MASCHIO TESTA ESAGONALE ZINCATO

- GALVANIZED HEXAGONAL PLUG
- 6-KANT STOPFEN VERZINKT
- BOUCHON MALE HEXAGONAL GALVANISÉ
- TAPÓN MACHO HEXAGONAL GALVANIZADO

**NORM:** UNI / DIN EN 10241 (ex DIN 2982)

**THREAD:** EN 10226-1 (ex ISO 7/1)

CODE	DN	DN inch	T mm	SW mm	L mm			
292104001	8	1/4"	4,5	14	15	10	10	200*
292308001	10	3/8"	5	19	17	23	10	200*
292102001	15	1/2"	6	22	20	30	10	200*
292304001	20	3/4"	6	30	24	74	10	100*
292100001	25	1"	8	36	26	146	10	100*
292114001	32	1"1/4"	7	42	22	140	5*	50
292112001	40	1"1/2"	8	50	25	215	5*	50
292200001	50	2"	8	60	25	280	5*	25

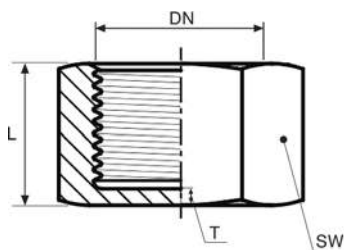

[\*] unità minima di vendita/minimum selling quantity

R1014

**300****CALOTTA ESAGONALE ZINCATA**

- GALVANIZED HEXAGONAL CAP
- 6-KANT KAPPE VERZINKT
- BOUCHON FEMELLE HEXAGONAL GALVANISÉ
- TAPÓN HEMBRA HEXAGONAL GALVANIZADO

**TYPE:** International Nr. 19  
**NORM:** UNI / DIN EN 10241 (ex DIN 2982)  
**THREAD:** EN 10226-1 (ex ISO 7/1)

CODE	DN	DN inch	T mm	SW mm	L mm			
300104004	8	1/4"	3,5	17	15	20	10	200*
300308004	10	3/8"	3,5	21	17	30	10	200*
300102004	15	1/2"	4	25	19	45	10	200*
300304004	20	3/4"	4	32	22	80	10	100*
300100004	25	1"	4,5	38	23	120	10*	100
300114004	32	1 1/4"	5	46	19	150	5*	50
300112004	40	1 1/2"	5,5	60	22	240	5*	50

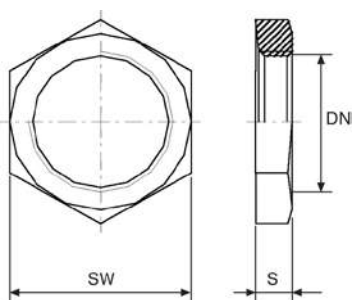

[\*] unità minima di vendita/minimum selling quantity

R1014

**310****GHIERA ESAGONALE ZINCATA**

- GALVANIZED BACKNUT
- 6-KANT GEGENMUTTER VERZINKT
- CONTRE ECROU GALVANISÉ
- TUERCA HEXAGONAL GALVANIZADO

**TYPE:** International Nr. 21  
**NORM:** UNI / DIN EN 10241 (ex DIN 2982)  
**THREAD:** ISO 228/1 (ex DIN 259)

CODE	DN	DN inch	S mm	SW mm			
310108001	6	1/8"	6,5	17	8	10*	100
310104001	8	1/4"	6,5	19	13	10*	200
310308001	10	3/8"	7	24	23	10	200*
310102001	15	1/2"	8	30	30	10	200*
310304001	20	3/4"	9	36	46	10	150*
310100001	25	1"	9,5	41	127	10*	150

[\*] unità minima di vendita/minimum selling quantity

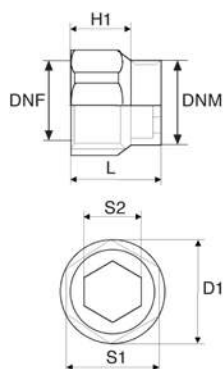



529

R1014

## MANICOTTO MF (PROLUNGA) ZINCATO

- GALVANIZED HEXAGONAL NEGATIVE BUSHUNG MF
- MUFFENNIPPEL VERZINKT
- MANCHON DE PROLONGEMENT GALVANISÉ
- MANGUITO MH GALVANIZADO

THREAD: ISO 228/1 (ex DIN 259)

CODE	DN	DN inch	H1 mm	L mm	D1 mm	S1 mm	S2 mm			
529308100	10	3/8"	10	18	21	20	9	19	10	200*
529308150			15	23	21	20	9	21	10	200*
529308200			20	28	21	20	9	28	10	200*
529308250			25	33	21	20	9	33	10*	200
529308300			30	38	21	20	9	38	10*	200
529308350			35	44	20	-	9	41	10*	100
529308400			40	49	20	-	9	50	10*	100
529308500			50	59	20	-	9	64	10*	50
529102100			15	1/2"	10	22,5	25	24	12	28
529102150	15	25,5			25	24	12	30	10	200*
529102200	20	30,5			25	24	12	38	10	150*
529102250	25	35,5			25	24	12	45	10	100*
529102300	30	40,5			25	24	12	53	10	100*
529102350	35	47			25	24	12	63	10**	100
529102400	40	49			25	-	12	62	10	100*
529102500	50	60			25	24	12	69	10	100*
529304100	20	3/4"			10	22,5	32	30	16	38
529304150			15	25,5	32	30	16	44	10	100*
529304200			20	30,5	32	30	16	56	10	100**
529304250			25	34	30	-	14	62	10*	100
529304300			30	41	30	-	14	71	10	100**
529304350			35	45	31	30	14	83	10*	50
529304400			40	50	30	-	15	90	10*	50
529304500			50	60	30	-	15	109	10*	50
529100100			25	1"	10	23	38	-	19	64
529100150	15	26			38	-	19	69	10*	50
529100200	20	30			38	-	19	85	5*	50
529100250	25	35			38	-	19	107	5*	50
529100300	30	39			38	-	19	128	5*	50
529100400	40	51			38	-	19	156	5*	25
529100500	50	62	40	38	19	224	5**	25		

[\*] unità minima di vendita/minimum selling quantity

R1014

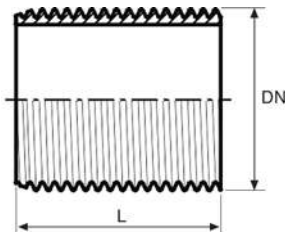



531

## NIPPLO SEMPLICE ZINCATO

- GALVANIZED PARALLEL NIPPLE
- GEWINDENIPPEL VERZINKT
- MAMELON SIMPLE GALVANISÉ
- MANGUITO INTERIOR GALVANIZADO

**TYPE:** International Nr. 22  
**THREAD:** ISO 228/1 (ex DIN 259)

CODE	DN	DN inch	L mm			
531104004	8	1/4"	18	10	10*	100
531308004	10	3/8"	22	20	10*	200
531102004	15	1/2"	25	30	10	200*
531304004	20	3/4"	30	60	10	100*
531100004	25	1"	35	105	10	100*
531114004	32	1 1/4"	38	95	5*	50
531112004	40	1 1/2"	38	145	5*	50
531200004	50	2"	45	200	5*	20

(\*) unità minima di vendita/minimum selling quantity

## ACCOPIAMENTO A TENUTA SUL FILETTO

Norma EN 10226-1 (ex ISO 7/1)

Filettatura gas:

**maschio conico [ designazione R ]**

**femmina cilindrica [ designazione Rp ]**

## COUPLING WITH SEAL ON THE THREAD

EN 10226-1 (ex ISO 7/1) standard

Gas thread:

**conical male [ designation R ]**

**cylindrical female [ designation Rp ]**

ACCOPIAMENTO CON GUARNIZIONE PIATTA  
(NON A TENUTA SUL FILETTO)

Norma ISO 228

Filettatura gas:

**maschio cilindrico [ designazione G (A o B) ]**

**A o B = classi di tolleranza ]**

**femmina cilindrica [ designazione G ]**

COUPLING WITH FLAT GASKET  
(NOT HOLDING THE THREAD)

ISO 228 standard

Gas thread:

**cylindrical male [ designation G (A or B) ]**

**A or B = tolerance classes ]**

**cylindrical female [ designation G ]**