

RIDUZIONI CONCENTRICHE

(senza saldatura)

ASME B 16.9 ASTM A 403

CERTIFICATI EN 10204/3.1B

CONCENTRIC REDUCERS

(seamless)

ASME B 16.9 ASTM A 403

CERTIFICATES EN 10204/3.1B

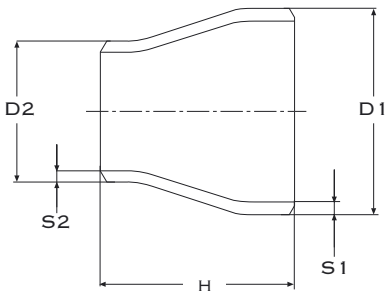

CARATTERISTICHE TECNICHE

ESECUZIONE: senza saldatura

MARCATURA: marchio del produttore;
numero di colata, dimensioni, tipo di acciaio

CERTIFICATI EN 10204/3.1B

TECHNICAL INFORMATION

EXECUTION: seamless

MARKING: producer's name;
heat number, dimensions, steel

CERTIFICATES EN 10204/3.1B

Ø est. x Ø est. Outs. Ø x Outs. Ø	Sp. x Sp. mm Thck. x Thck. mm	Dimensioni Dimensions	Peso teorico Kg/pz. Theoric weight Kg/pcs.	Tipo Type	H
21.34 x 13.72	2.11 x 1.65	1/2" x 1/4" SCH 10S	0.020	A-403	38.1
21.34 x 13.72	2.77 x 2.24	1/2" x 1/4" SCH 40S	0.030	A-403	38.1
21.34 x 17.15	2.11 x 1.65	1/2" x 1/4" SCH 10S	0.020	A-403	38.1
21.34 x 17.15	2.77 x 2.31	1/2" x 3/8" SCH 40S	0.030	A-403	38.1
26.67 x 21.33	2.11 x 2.11	3/4" x 1/2" SCH 10S	0.043	A-403	38.1
26.67 x 21.33	2.87 x 2.77	3/4" x 1/2" SCH 40S	0.059	A-403	38.1
26.67 x 21.33	3.91 x 3.73	3/4" x 1/2" SCH 80S	0.075	A-403	38.1
33.40 x 21.33	2.77 x 2.11	1" x 1/2" SCH 10S	0.086	A-403	50.8
33.40 x 21.33	3.38 x 2.77	1" x 1/2" SCH 40S	0.105	A-403	50.8
33.40 x 21.33	4.55 x 3.73	1" x 1/2" SCH 80S	0.133	A-403	50.8
33.40 x 26.67	2.77 x 2.11	1" x 3/4" SCH 10S	0.095	A-403	50.8
33.40 x 26.67	3.38 x 2.87	1" x 3/4" SCH 40S	0.116	A-403	50.8
33.40 x 26.67	4.55 x 3.91	1" x 3/4" SCH 80S	0.147	A-403	50.8
42.16 x 21.30	2.77 x 2.11	1.1/4" x 1/2" SCH 10S	0.103	A-403	50.8
42.16 x 21.30	3.56 x 2.77	1.1/4" x 1/2" SCH 40S	0.132	A-403	50.8
42.16 x 21.30	4.85 x 3.73	1.1/4" x 1/2" SCH 80S	0.171	A-403	50.8
42.16 x 26.67	2.77 x 2.11	1.1/4" x 3/4" SCH 10S	0.111	A-403	50.8
42.16 x 26.67	3.56 x 2.87	1.1/4" x 3/4" SCH 40S	0.143	A-403	50.8
42.16 x 26.67	4.85 x 3.91	1.1/4" x 3/4" SCH 80S	0.187	A-403	50.8
42.16 x 33.40	2.77 x 2.77	1.1/4" x 1" SCH 10S	0.122	A-403	50.8
42.16 x 33.40	3.56 x 3.38	1.1/4" x 1" SCH 40S	0.157	A-403	50.8
42.16 x 33.40	4.85 x 4.55	1.1/4" x 1" SCH 80S	0.206	A-403	50.8
48.26 x 21.30	2.77 x 2.11	1.1/2" x 1/2" SCH 10S	0.142	A-403	63.5
48.26 x 21.30	3.68 x 2.77	1.1/2" x 1/2" SCH 40S	0.183	A-403	63.5
48.26 x 21.30	5.08 x 3.73	1.1/2" x 1/2" SCH 80S	0.242	A-403	63.5
48.26 x 26.67	2.77 x 2.11	1.1/2" x 3/4" SCH 10S	0.153	A-403	63.5
48.26 x 26.67	3.68 x 2.87	1.1/2" x 3/4" SCH 40S	0.201	A-403	63.5
48.26 x 26.67	5.08 x 3.91	1.1/2" x 3/4" SCH 80S	0.266	A-403	63.5
48.26 x 33.40	2.77 x 2.77	1.1/2" x 1" SCH 10S	0.166	A-403	63.5
48.26 x 33.40	3.68 x 3.38	1.1/2" x 1" SCH 40S	0.219	A-403	63.5
48.26 x 33.40	5.08 x 4.55	1.1/2" x 1" SCH 80S	0.291	A-403	63.5
48.26 x 42.16	2.77 x 2.77	1.1/2" x 1.1/4" SCH 10S	0.184	A-403	63.5
48.26 x 42.16	3.68 x 3.56	1.1/2" x 1.1/4" SCH 40S	0.243	A-403	63.5
48.26 x 42.16	5.08 x 4.85	1.1/2" x 1.1/4" SCH 80S	0.324	A-403	63.5
60.33 x 21.30	2.77 x 2.11	2" x 1/2" SCH 10S	0.225	A-403	76.1
60.33 x 21.30	3.91 x 2.77	2" x 1/2" SCH 40S	0.279	A-403	76.1
60.33 x 21.30	5.54 x 3.73	2" x 1/2" SCH 80S	0.379	A-403	76.1
60.33 x 26.67	2.77 x 2.11	2" x 3/4" SCH 10S	0.217	A-403	76.1
60.33 x 26.67	3.91 x 2.87	2" x 3/4" SCH 40S	0.300	A-403	76.1
60.33 x 26.67	5.54 x 3.91	2" x 3/4" SCH 80S	0.406	A-403	76.1
60.33 x 33.40	2.77 x 2.77	2" x 1" SCH 10S	0.233	A-403	76.1
60.33 x 33.40	3.91 x 3.38	2" x 1" SCH 40S	0.322	A-403	76.1
60.33 x 33.40	5.54 x 4.55	2" x 1" SCH 80S	0.438	A-403	76.1
60.33 x 42.16	2.77 x 2.77	2" x 1.1/4" SCH 10S	0.254	A-403	76.1
60.33 x 42.16	3.91 x 3.56	2" x 1.1/4" SCH 40S	0.352	A-403	76.1
60.33 x 42.16	5.54 x 4.85	2" x 1.1/4" SCH 80S	0.478	A-403	76.1
60.33 x 48.26	2.77 x 2.77	2" x 1.1/2" SCH 10S	0.269	A-403	76.1
60.33 x 48.26	3.91 x 3.68	2" x 1.1/2" SCH 40S	0.372	A-403	76.1
60.33 x 48.26	5.54 x 5.08	2" x 1.1/2" SCH 80S	0.508	A-403	76.1
73.03 x 42.16	3.05 x 2.77	2.1/2" x 1.1/4" SCH 10S	0.370	A-403	88.9
73.03 x 42.16	5.16 x 3.56	2.1/2" x 1.1/4" SCH 40S	0.631	A-403	88.9
73.03 x 42.16	7.01 x 4.85	2.1/2" x 1.1/4" SCH 80S	0.789	A-403	88.9
73.03 x 48.30	3.05 x 2.77	2.1/2" x 1.1/2" SCH 10S	0.388	A-403	88.9
73.03 x 48.30	5.16 x 3.68	2.1/2" x 1.1/2" SCH 40S	0.661	A-403	88.9
73.03 x 48.30	7.01 x 5.08	2.1/2" x 1.1/2" SCH 80S	0.831	A-403	88.9
73.03 x 60.30	3.05 x 2.77	2.1/2" x 2" SCH 10S	0.426	A-403	88.9
73.03 x 60.30	5.16 x 3.91	2.1/2" x 2" SCH 40S	0.724	A-403	88.9
73.03 x 60.30	7.01 x 5.54	2.1/2" x 2" SCH 80S	0.919	A-403	88.9
88.90 x 33.40	3.05 x 2.77	3" x 1" SCH 10S	0.426	A-403	88.9