

CARTELLE INOX
AISI 304L e AISI 316L
EN 1.4307 e EN 1.4404

STAINLESS STEEL WELDING COLLARS
AISI 304L and AISI 316L
EN 1.4307 and EN 1.4404

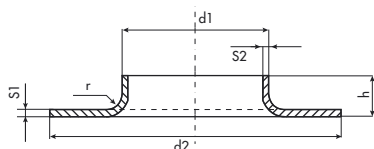

DN	Ø D ₁	D ₂	H	R	Peso Weight	
					2,00 mm	3,00 mm
15	21,3	45	6	3,0	0,010	0,015
20	26,9	58	6	3,0	0,040	0,060
25	33,7	68	8	3,0	0,050	0,075
32	42,4	78	10	3,0	0,070	0,105
40	48,3	88	10	3,0	0,080	0,110
	54	105	12	3,0	0,100	//
50	60,3	102	12	3,0	0,110	0,140
65	76,1	122	12	3,0	0,150	0,200
	84	140	12	3,0	0,200	//
80	88,9	139	12	3,0	0,190	0,250
	101,6	158	12	3,0	0,210	0,280
	104	160	12	3,0	0,280	//
100	114,3	158	14	3,0	0,210	0,290
	129	190	12	3,0	0,350	//
125	139,7	188	14	4,0	0,260	0,430
	154	215	16	3,0	0,380	//
150	168,3	212	16	4,0	0,340	0,520
	204	270	18	4,0	0,500	//
200	219,1	270	18	5,0	0,530	0,760
	254	325	20	5,0	0,640	//
250	273,0	320	20	5,0	0,580	0,820
	304	375	22	5,0	0,850	//
300	323,9	370	25	5,0	0,650	1,060
350	355,6	430	25	5,0	//	2,100
400	406,4	482	25	5,0	//	1,740
450	457,2	532	25	5,0	//	2,250
500	508	585	25	5,0	//	2,900
600	609,6	685	30	5,0	//	3,500

CARATTERISTICHE TECNICHE

Esecuzione e tolleranze secondo ISO 5251

Acciaio: AISI 304L oppure AISI 316L

EN 1.4307 oppure EN 1.4404

3 righe fino al DN 150 misure gas

Estremità: lisce

Marcatura: con inchiostro indelebile o punzone riportante marchio del produttore, dimensioni, nr. di colata

CERTIFICATI: EN 10204/3.1B

TECHNICAL INFORMATION

Execution and tolerance according to ISO 5251

Steel: AISI 304L or AISI 316L

EN 1.4307 or EN 1.4404

3 lines until ND 150 (gas measures)

Smooth ends

Marking: indelible ink or punch reporting producer's name, dimensions, heat number

CERTIFICATES: EN 10204/3.1B

- ☒ = Disponibile a magazzino/stock On stock
 ✦ = Disponibile a richiesta On request
 // = Non fornibile Not supplied